

CERTIFICATE
Paid USD 4370 Stamp Duty and fees
Receipt No P209898 Dated 15/02/18

000 686/2015

Deduction Fees Paid
Amount: \$100
Receipt No: 821621
Date: 27/5/18 Surveyor General

DEED OF TRANSFER

**RNDLOVU & COMPANY
LEGAL PRACTITIONER
BULAWAYO**

Prepared by me

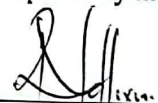
Conveyancer

Appearer: **ROBERT NDLOVU**

Power of Attorney: Given at BULAWAYO on the 13th of December 2017.

Transferor: KIKINS PHYSANT
(Born 15/06/1929) ID No. 08-049779 J00
(represented by Hetitage Maparara in his capacity as
he Additional Sheriff as per the High Court Order
granted by the High Court of Zimbabwe on the 10th of
August 2017 under case No. HC 1762/17)

Transferee: POLECAT INVESTMENTS (PRIVATE) LIMITED

Reason of Transfer: Sale

Property/.....

-1-

Property description: Certain piece of land situate in the District of Bulalima Mangwe

Being: Lot 2 of Natane measuring 674,0711 Hectares.

Extending: As appears from diagram annexed to Deed of Grant No: 5441 passed in favour of Henry Llewellyn Lloyd on the 27th March 1901 and to the diagram of the said Lot 2 (SG No. 88/2016) hereto annexed.

Current Holding Deed: 1465/83 dated 1st June 1983 in favour of PHYSANT KIKINS

SUBJECT

to all such applicable terms and conditions as are in the said Deeds mentioned or referred to,

ACKNOWLEDGING that satisfactory arrangements have been made for the payment of the purchase price of USD \$ 140 000.00

SIGNED/.....



SIDES		DIRECTIONS	Lo 29°		CO-ORDINATES		DIAGRAM S.G. No.	
metres		° ' "	Y		metres X		88/2016	
		Const:	+ 0,00		+ 2 200 000,00		Sheet 1 of 2 Sheets	
AB	104, 57	254 40 00	A	+	102 592,34	+	67 075,04	RL17
BC	366, 24	246 42 20	B	+	102 491,50	+	67 047,39	RL16
CD	172, 26	235 10 50	C	+	102 155,11	+	66 902,55	RL15
DE	569, 78	222 40 20	D	+	102 013,69	+	66 804,19	RL14
EF	146, 68	216 43 30	E	+	101 627,50	+	66 385,25	RL13
FG	140, 35	201 42 00	F	+	101 539,79	+	66 267,69	RL12
GH	189, 30	195 37 00	G	+	101 487,90	+	66 137,28	RL11
HJ	94, 02	206 34 20	H	+	101 436,94	+	65 954,97	RL10
JK	112, 46	214 47 40	J	+	101 394,88	+	65 870,88	RL9
KL	243, 76	222 33 30	K	+	101 330,71	+	65 778,53	RL8
LM	194, 65	228 25 30	L	+	101 165,84	+	65 598,98	RL7
MN	743, 15	234 16 20	M	+	101 020,23	+	65 469,81	RL6
NP	100, 74	237 34 30	N	+	100 416,94	+	65 035,87	RL5
PQ	175, 02	247 48 50	P	+	100 331,90	+	64 981,86	RL4
QR	1 317, 63	264 13 00	Q	+	100 169,84	+	64 915,76	RL3
RS	149, 93	275 52 20	R	+	98 858,92	+	64 782,98	RL2
ST	309, 04	284 02 30	S	+	98 709,77	+	64 798,32	RL1
TU	1 668, 45	314 08 40	T	+	98 409,97	+	64 873,31	MA12
UV	1 948, 69	68 54 20	U	+	97 212,70	+	66 035,32	Bes17
VW	3 564, 88	83 35 40	V	+	99 030,79	+	66 736,71	Bes14
WX	43, 75	160 27 00	W	+	102 573,42	+	67 134,37	DN
XA	18, 60	166 42 00	X	+	102 588,06	+	67 093,14	E

Sheet 1 of 2 Sheets

Beacon Descriptions

All others : 16mm iron peg in concrete and cairn
 U, X : 12mm iron peg and cairn
 V : hole on rock and cairn

Approved

[Signature]
 for Surveyor - General
 26/07/2016

BINDING MARGIN NOT TO BE WRITTEN IN

The figure A. B. C. D. E. F. G. H. J. K. L. M. N. P. Q. R. S. T. U. V. W. X. A.

represents 674,0711 hectares of land called

LOT 2 OF NATANE

situate in the district of Bulalima Mangwe
 Surveyed in October, 2015 by me

[Signature]
 Land Surveyor

This diagram is annexed to <i>Tfr.</i> No. 686/2018 dated 29.5.2018	The immediate parent diagram is No. 1027/01 annexed to		The original title diagram is No. 1027/01 annexed to	
	Grant	No. 1879	Grant	No. 1879
	File :	G.P	S.R	70/2016
Surveyor-General.	Compilation : 2028 A3			

BINDING MARGIN NOT TO BE WRITTEN IN

M. J. Ammerlaan
Land Surveyor

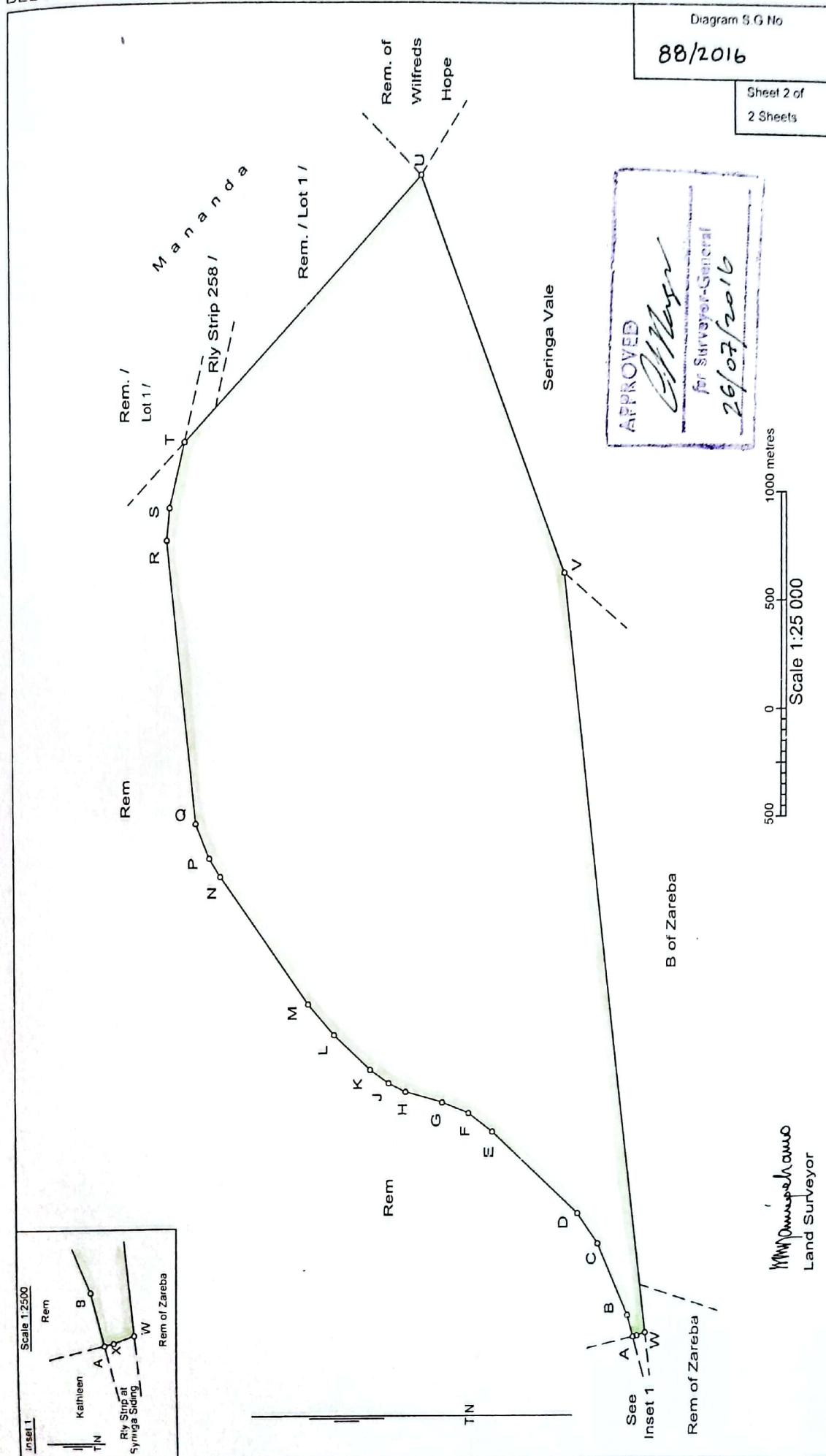

SIGNED and SEALED at BULAWAYO on this
2018

29TH

Day of MAY



q.q His Principal/s

In my presence



REGISTRAR OF DEEDS

000 606/2018